



External Catheter Evacuation

User Manual



When a restroom isn't convenient

Introduction

External catheters let users urinate while mobile, allowing urine to flow by gravity into a collection bag. However, urine doesn't drain from the catheter and tubing until it's removed. This can be unsanitary and make removal a bit messy.

The PureFlow system adds a patent pending evacuation valve between the catheter and the drainage tube.

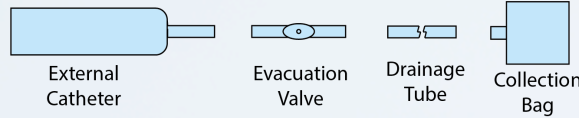

System Diagram

When urine flows into the tube, its weight opens a check valve allowing air to enter and the urine to drain from the catheter and tubing. This design improves sanitation and eliminates spillage during catheter removal.

Operation



System Components

The system consists of the evacuation valve, the external catheter and velcro strap and the collection bag. The

package also contains a compression sleeve, a large and small connector tube, two leg bag straps and a funnel for cleaning the system.

Setup

- Put the compression sleeve over the ankle and calf. Insert the leg bag straps into the collection bag and attach the bag to the calf.
- The drainage tube on the collection bag needs to be shortened to a user specific length. After completing Usage step 3 (below), with the leg bag in place, attach the smaller connector tube to the evacuation valve. Cut the drainage tube where it meets the connector tube, leaving an inch or two of play.



Usage

1. Make sure the drainage valve on the collection bag is closed.

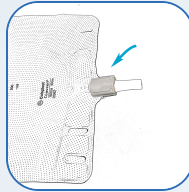

2. Select a catheter size that fits snugly. Insert the long end of the evacuation valve into the catheter tube.

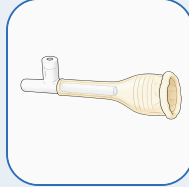

3. Unroll the catheter onto the penis and secure with the velcro strap.

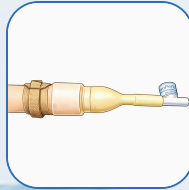

4. Connect the collection bag drainage tube to the evacuation valve using the small connector tube.

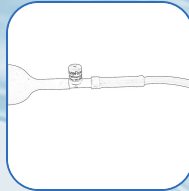

Cleanup

External catheters can cause skin irritation for some users.

Manufacturers recommend changing the catheter every 24 hours. We recommend changing it every 8 hours until you know your tolerance level. If

it's a problem, use a barrier film spray or wipe such as 3M Cavilon.

Cleanup

- The bag can be drained without removing it by placing your foot on the edge of the toilet and opening the valve to allow the urine to drain.
- To remove the system, disconnect the evacuation valve from the connector tube. Remove the velcro strap, remove the catheter and remove the evacuation valve from the catheter. Remove the collection bag from the leg.

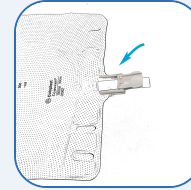

Connect the funnel to the smaller connector tube with the larger connector tube. Pour at least a couple cups of water into the funnel. Mix the water in the bag and drain the bag again. Once a month, add some bleach to the rinse water.

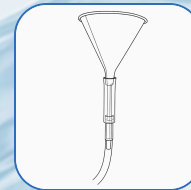

- Rinse the valve in water.



Contact Info

info@pureflowce.com

support@pureflowce.com

Warranty

The PureFlow™ Evacuation Valve is warranted to be free from defects in materials and workmanship for one year from the date of purchase under normal use.

FDA Registration: 3042365416