



External Catheter Evacuation

User Manual



Drive without stopping!

Introduction

External catheters let users urinate away from a restroom, allowing urine to flow by gravity into a collection bag. However, urine doesn't drain from the catheter and tubing until it's removed. This can be unsanitary and make removal a bit messy.

The PureFlow system adds a patent pending evacuation valve between the catheter and the drainage tube.

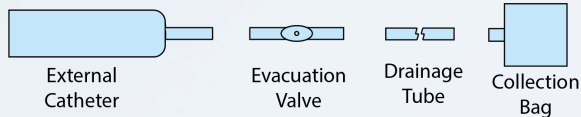

System Diagram

When urine flows into the tube, its weight opens a check valve allowing air to enter and the urine to drain from the catheter and tubing. This design improves sanitation and eliminates spillage during catheter removal.

Operation



System Components

The system consists of the evacuation valve, the external catheter and velcro strap, the drainage tube (with the blue

molded connectors) and the collection bag. The package also contains a drawstring bag, two end caps, and a funnel for cleaning the system.

Setup

- The collection bag should be placed on the floor so there are at least 6 inches from the evacuation valve to the bag inlet. This creates a vacuum from the fluid in the tube. Be sure the bag is positioned so that urine can flow freely from the tube into the bag without kinks or obstructions.

- Connect one end of the drainage tube to the collection bag tube.

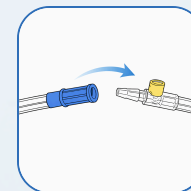

- The other end of the drainage tube will be connected to the evacuation valve. We recommend running it over the top of the pants, but running it inside the pant leg is also an option.

The collection bag can be kept in the drawstring bag to keep it out of sight and to transport it to the toilet.

Usage

1. Make sure the drainage valve on the collection bag is closed.

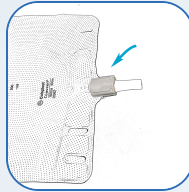

2. Select a catheter size that fits snugly. Insert the long end of the evacuation valve into the catheter tube.

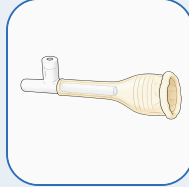

3. Unroll the catheter onto the penis and secure with the velcro strap.

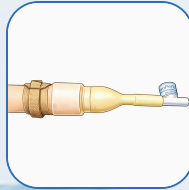

4. Insert the evacuation valve into the drainage tube connector. Close the pants with the tube running out of the top.

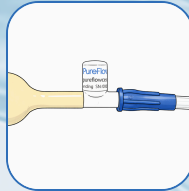

Disconnect & Cleanup

External catheters can cause skin irritation for some users. Manufacturers recommend changing the catheter every 24 hours. We recommend changing it every 8 hours

until you know your tolerance level. If it's a problem, use a barrier film spray or wipe such as 3M Cavilon.

Disconnect

- If the user needs to move about, the drainage tube can be removed from the evacuation valve. Place an end cap over the end of the evacuation valve.

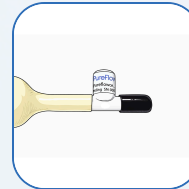

Cleanup

- Disconnect, then take the collection bag and drainage tube to the toilet. Open the valve on the collection bag to allow the urine to drain.
- Close the collection bag valve and insert the funnel into the drainage tube. Pour at least a couple cups of water into the funnel. Mix the water in the bag and drain the bag again. Once a month,

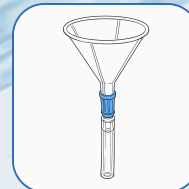
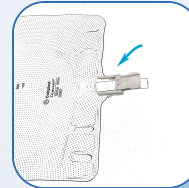

add some bleach to the rinse water.

- Remove the velcro strap, remove the catheter and remove the evacuation valve from the catheter. Rinse the valve.



Contact Info

info@pureflowce.com

support@pureflowce.com

Warranty

The PureFlow™ Evacuation Valve is warranted to be free from defects in materials and workmanship for one year from the date of purchase under normal use.

FDA Registration: 3042365416